

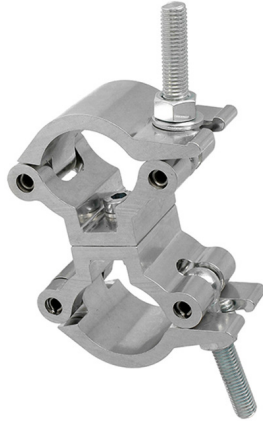

Product Data Sheet

Lightweight Parallel Coupler



A pair of half couplers which provide a firm fixing between two parallel bars.	
Part Nos	T58115 - Polished T58116 - Powder Painted Satin Black
Tube Diameter	Ø48 - 51mm
Materials	Main Body - AW6082 T6 Aluminium Roll Pins - Stainless Steel Eyebolt Assy - Grade 8.8
Max Tightening Torque	30Nm
Fixings	N/A
WLL	500Kg
Weight	0.76Kg
Factor of Safety	5:1
Approval	TÜV Approved

