

**COMPLETE STAND**

**PARTS LIST - PART NUMBERS IN BRACKETS**

**TOOLS NEEDED:  
2 X 13MM SPANNER**

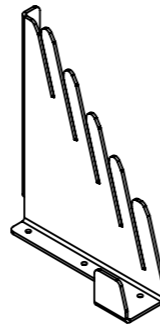

**X 1**  
(TH4848)

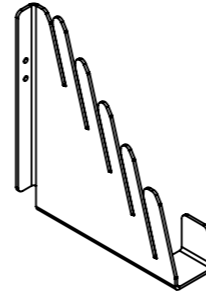

**X 1**  
(TH4849)

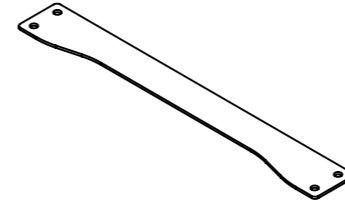

**X 1**  
(TH4851)

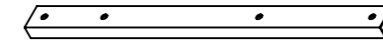

**X 2**  
(TH5141)

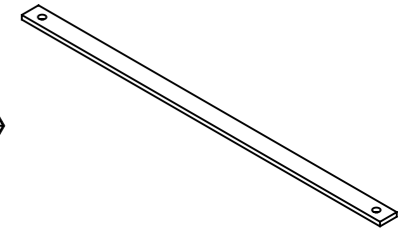

**X 2**  
(TH5059)

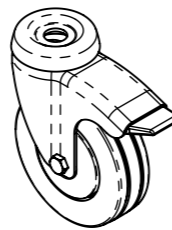

**X 2**  
(S3848)

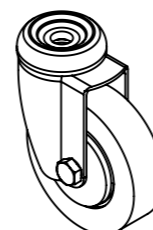

**X 2**  
(S3144)

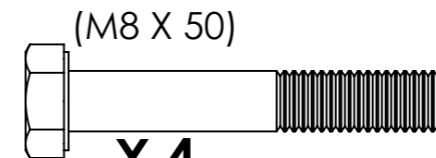

(M8 X 50)

**X 4**  
(F815)

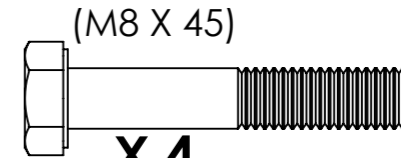

(M8 X 45)

**X 4**  
(F2504)

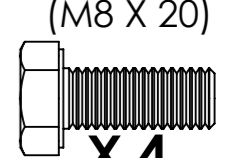

(M8 X 20)

**X 4**  
(F2501)

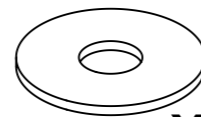

**X 16**  
(F1002)

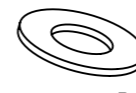

**X 4**  
(F891)

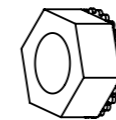

**X 12**  
(F936)

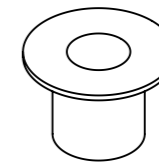

**X 4**  
(S3849)

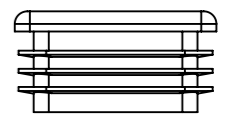

**X 4**  
(S3285)

**WHEN FINISHED: ENSURE ALL FASTENERS ARE NOW FULLY TIGHTENED**

**DOUGHTY**

**TITLE**  
TANK TRAP TROLLEY

**DWG NO**  
T54253

SHEET 1 OF 3

1. HAND TIGHTEN ALL FASTENERS UNTIL FINISHED

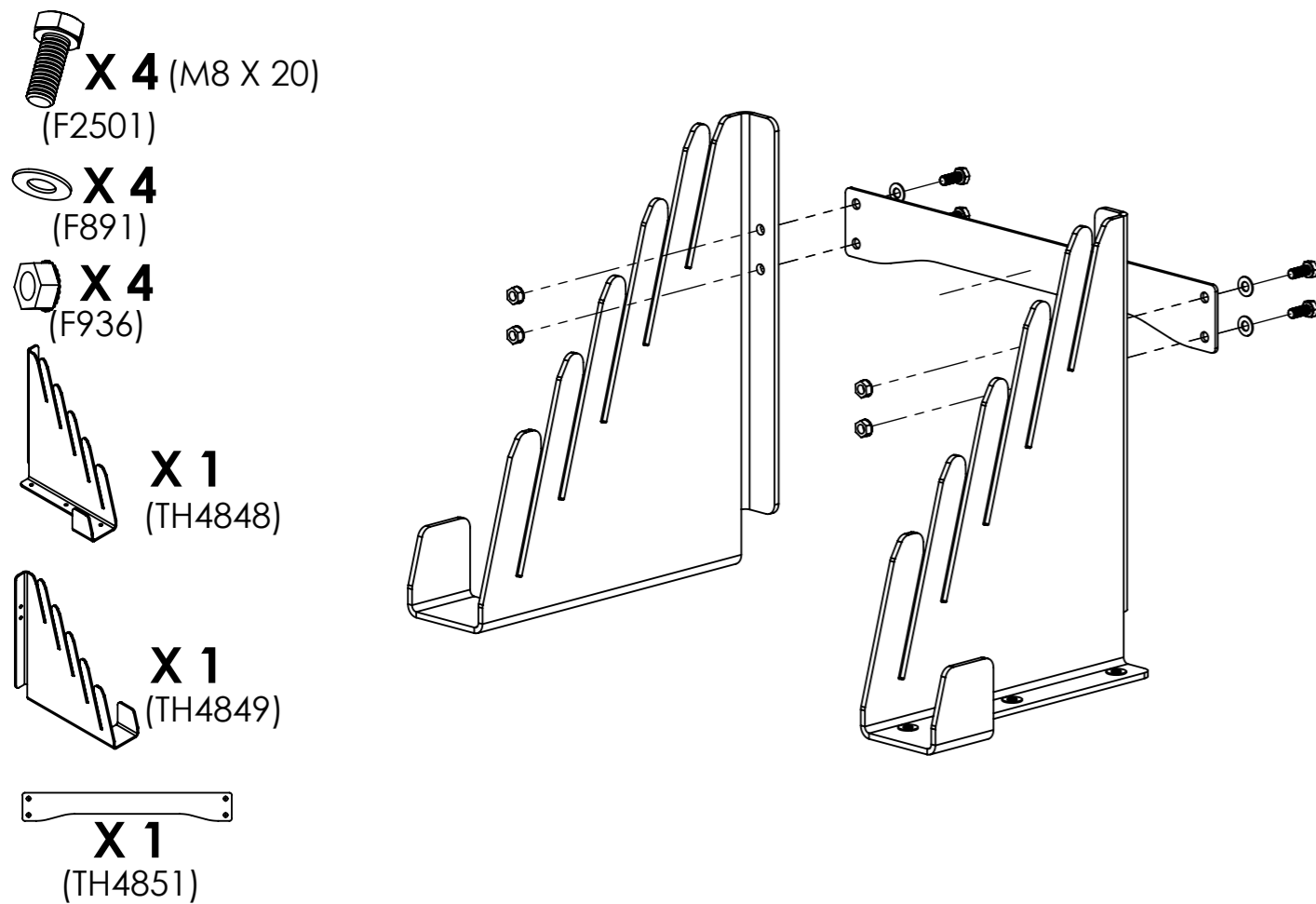

2.

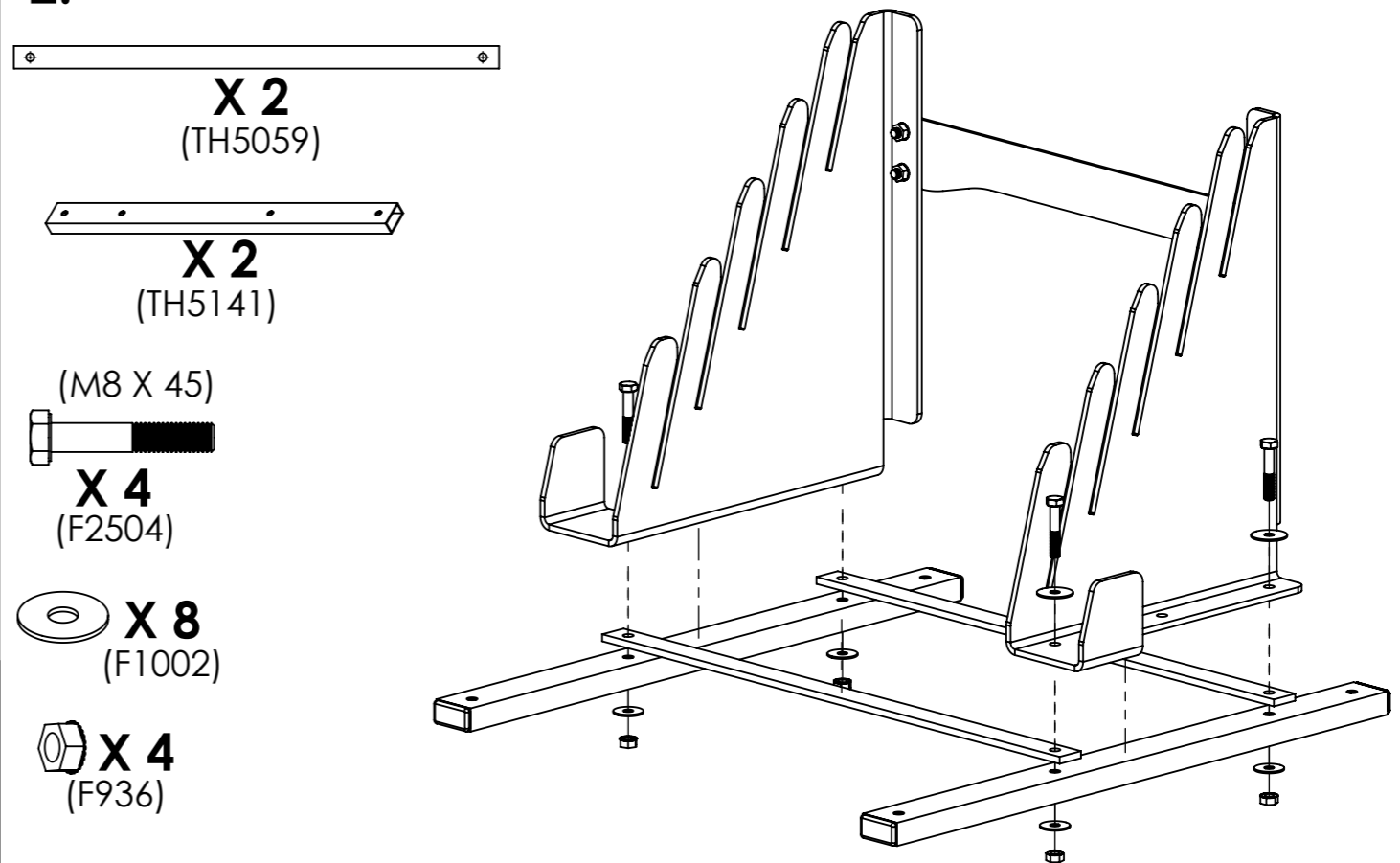

3.

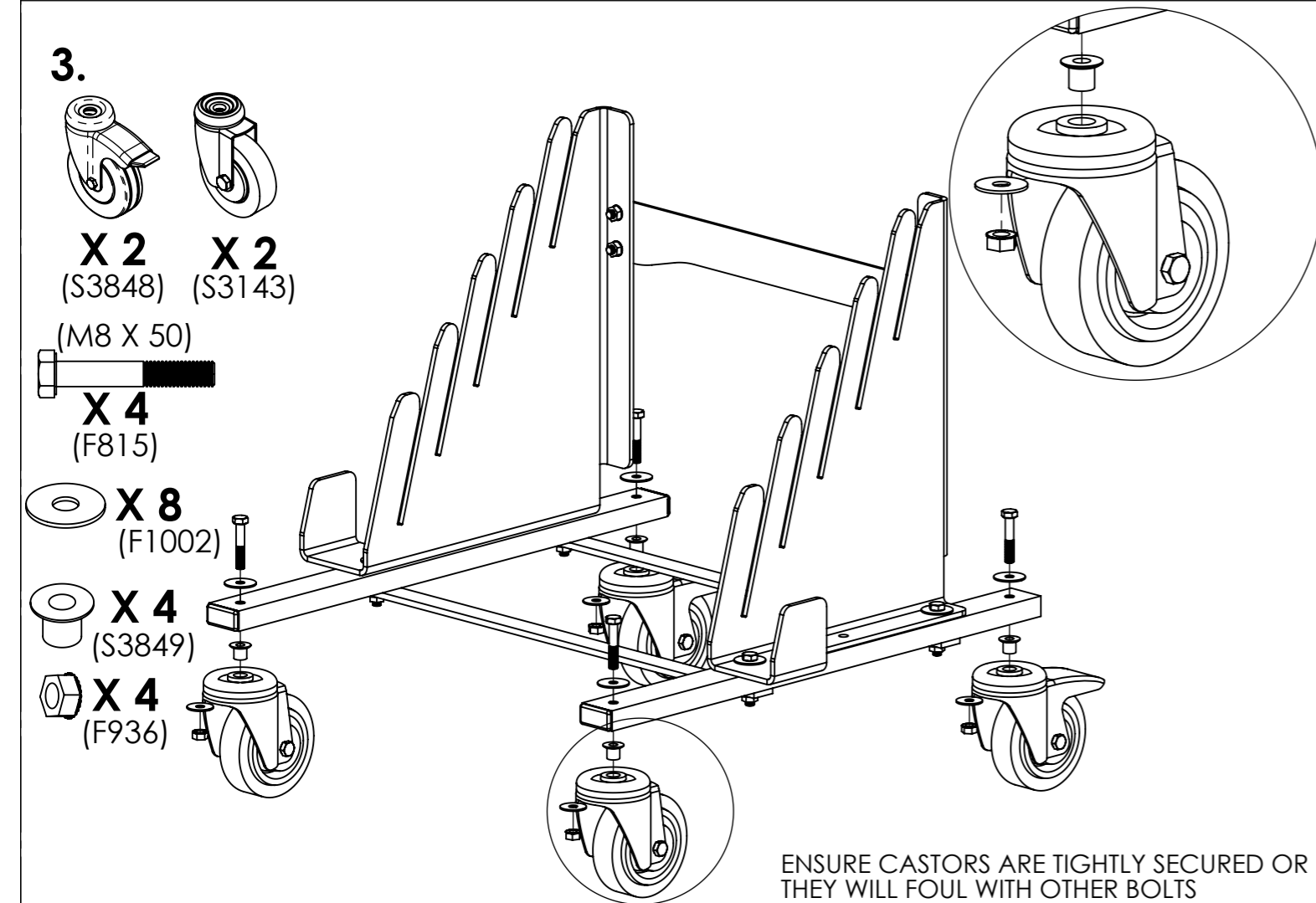

4.

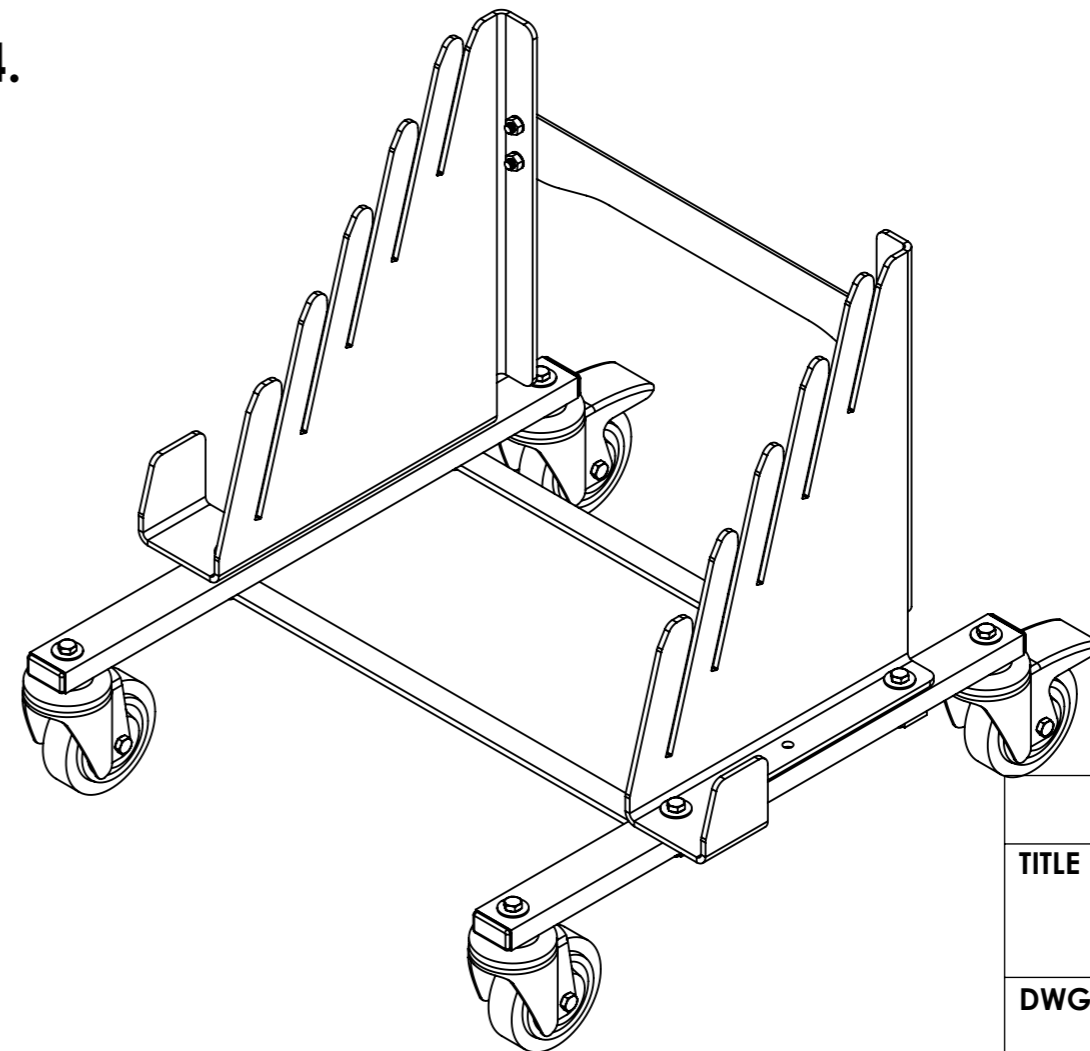

DOUGHTY

TITLE  
TANK TRAP TROLLEY

DWG NO  
T54253 SHEET 2 OF 3

1.



POTENTIAL FINGER TRAP

- i) START STACKING FROM THE FRONT OF THE RACK.
- ii) ENSURE TANK TRAP IS FACING SLOT SIDE UP.
- iii) PLEASE ENSURE TANK TRAP KNOB IS PARALLEL TO BASE PLATE.

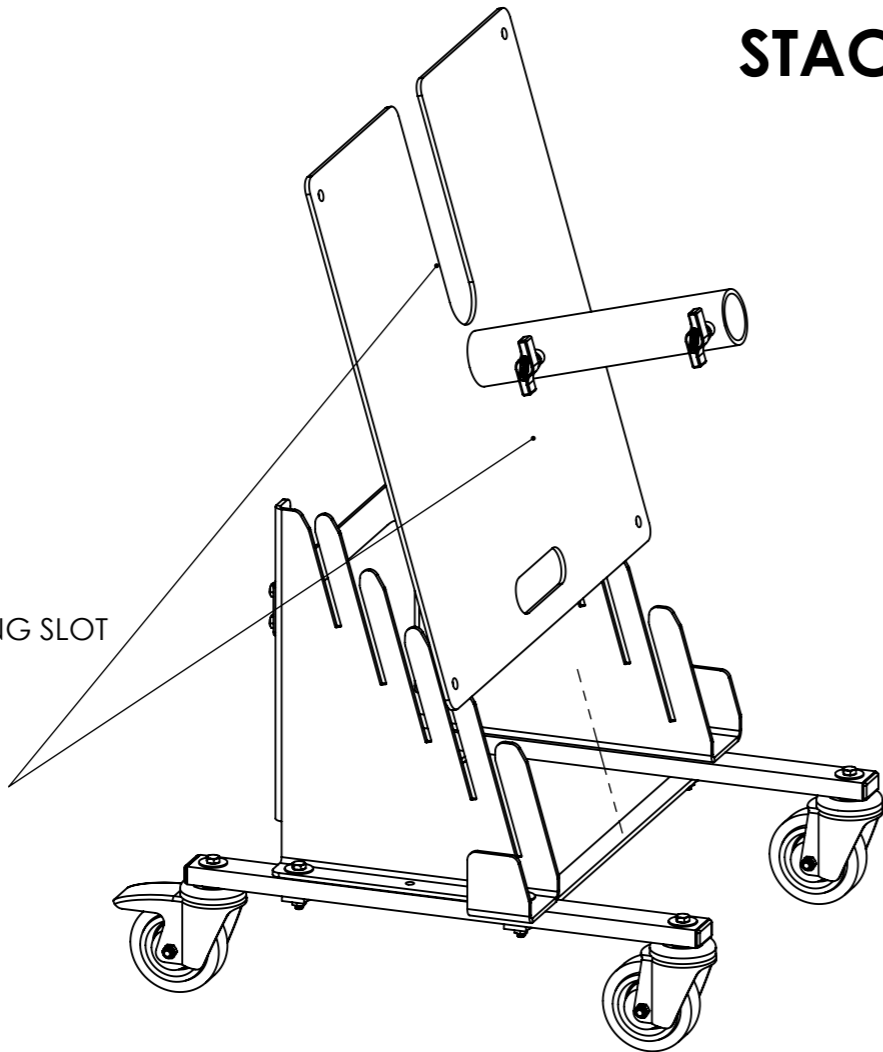

# STACKING INSTRUCTIONS

2.

- i) LINE UP SECOND TANK TRAP RECEIVER WITH THE SLOT ON THE FIRST PLATE
- ii) REPEAT STEP

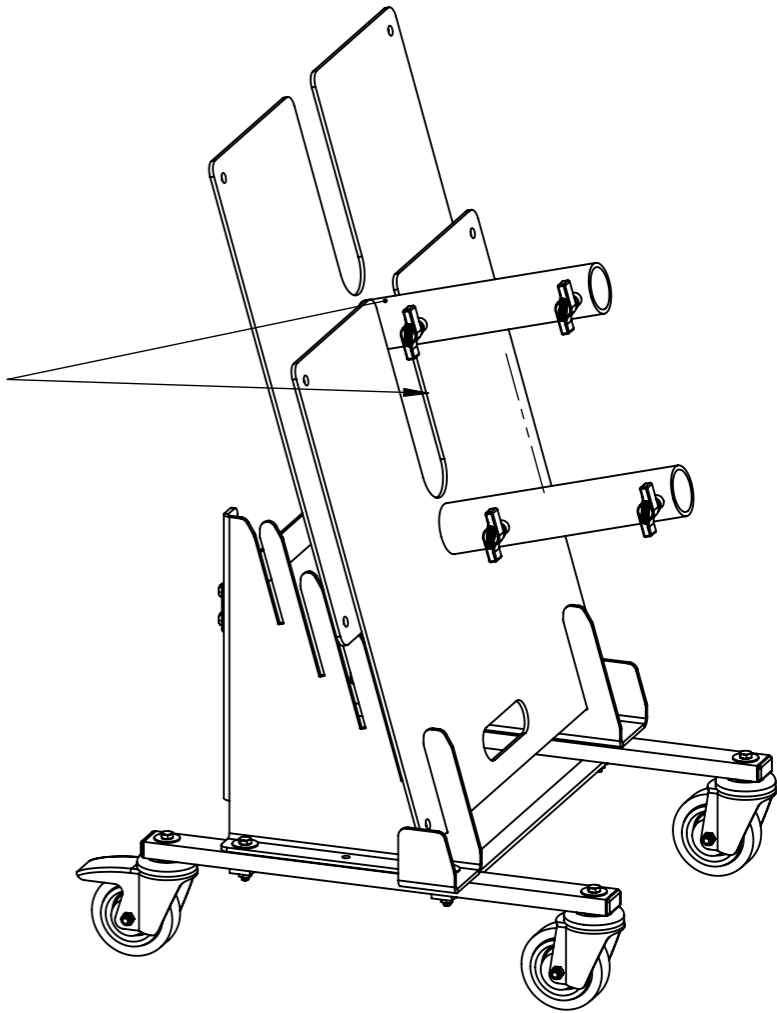

3.

- i) THE BOTTOM KNOB OF THE FOURTH TANK TRAP SLOTS BETWEEN THE BASE PLATES OF THE 1ST & 2ND TANK TRAPS.
- ii) ENSURE THE KNOB IS PARALLEL TO THE PLATE, OR IT WILL FOUL.

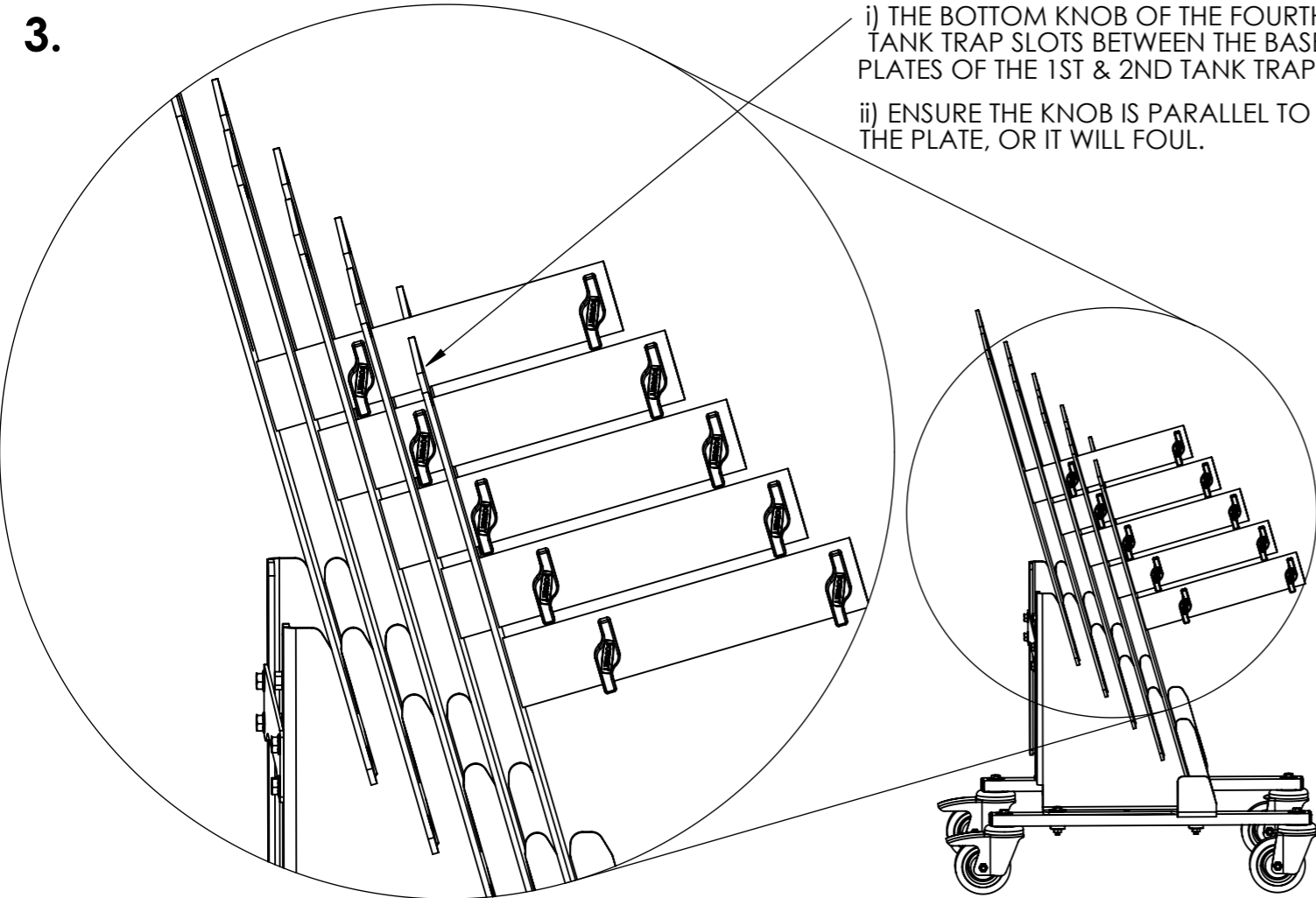

4.

- i) REPEAT STEP 3 FOR FINAL PLATE (BOTTOM KNOB WILL FIT BETWEEN SECOND AND THIRD BASE PLATES).

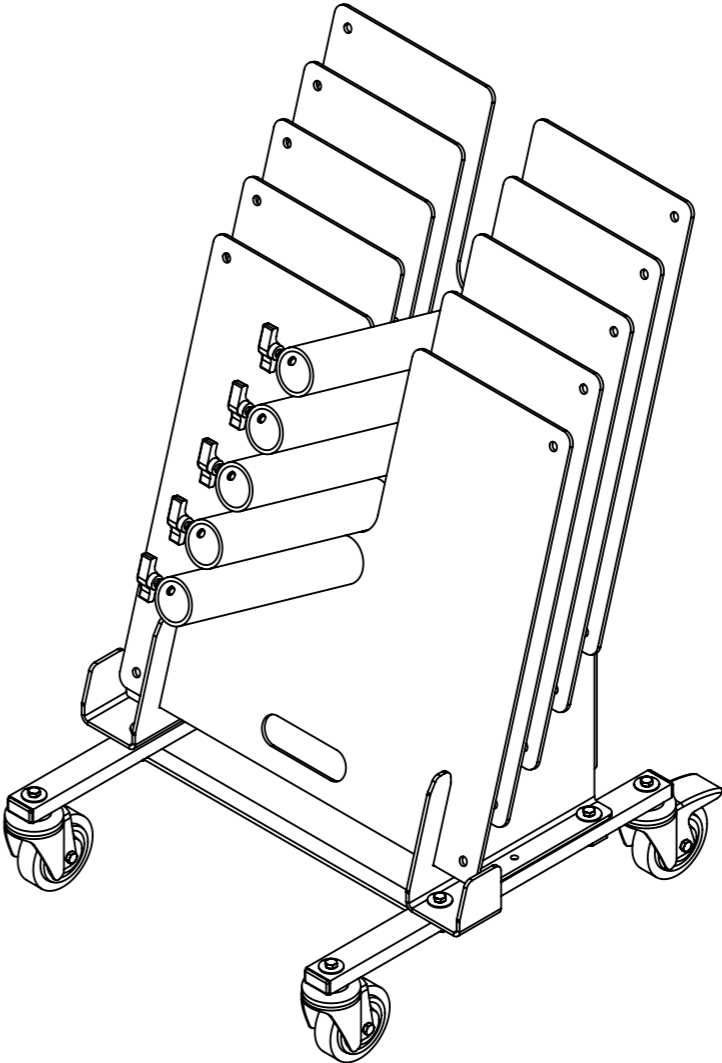

|         |                   |
|---------|-------------------|
| DOUGHTY |                   |
| TITLE   | TANK TRAP TROLLEY |
| DWG NO  | T54253            |
|         | SHEET 3 OF 3      |