



# Trigger TV Clamp



## Product Data Sheet



A Trigger Clamp fitted with a 29mm (1.14") Receiver	
<b>Part Nos</b>	T58869 - Polished T5886901 - Powder Painted Satin Black
<b>Tube Diameter</b>	Ø48 - 51mm (1.89" - 2.01")
<b>Materials</b>	Main Body - AW6082 T6 Aluminium Roll Pins - Stainless Steel Eyebolt Assy - Grade 8.8 Receiver - AW6082 T6 Aluminium
<b>Max Tightening Torque</b>	Hand-tight Only
<b>Fixings</b>	Fitted with a 29mm (1.14") Receiver
<b>WLL</b>	200Kg
<b>Weight</b>	1.09Kg (2.4 lbs)
<b>Factor of Safety</b>	5:1
<b>Approval</b>	TÜV Approved

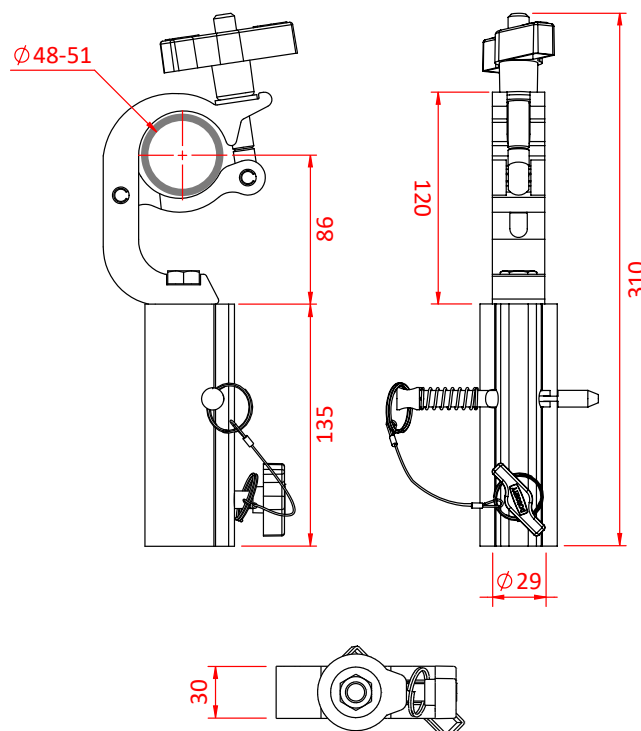

Dimensions in mm