



Aluminium Boom Arms - Black



Product Data Sheet



Aluminium Boom Arms	
Part Nos	T57311 - 250mm - 0.86Kg T57316 - 500mm - 1.27Kg T57318 - 750mm - 1.68Kg T57321 - 1000mm - 2.10Kg
Tube Diameter	Ø48 - 51mm
Materials	Main Body - 6082 T6 Aluminium Roll Pins - Stainless Steel Eyebolt Assy - Grade 8.8
Finish	Powder coated satin black
Max Tightening	30Nm
WLL	T57311 - 100Kg T57316 - 50Kg T57318 - 37Kg T57321 - 25Kg
Factor of Safety	5:1

Dimensions in mm

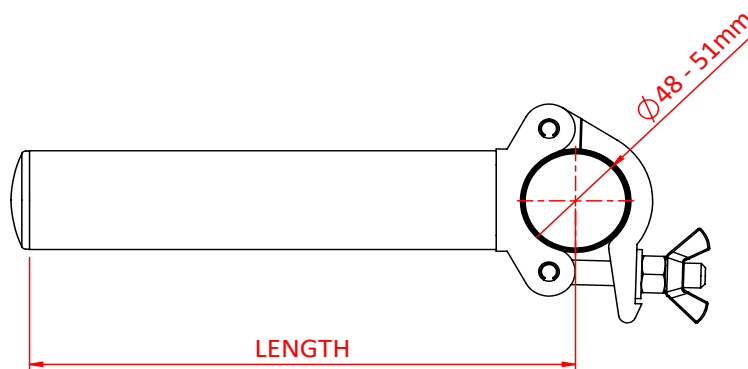
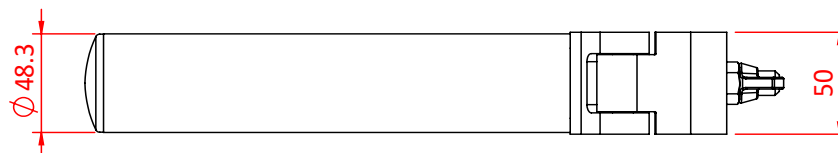

DIMENSIONS ARE A GUIDE ONLY AND MAY VARY

Doughty Engineering Ltd - Crow Arch Lane, Ringwood, Hampshire, BH24 1NZ, UK
+44 (0) 1425 478961, sales@doughty-engineering.co.uk - www.doughty-engineering.co.uk