



Aluminium Boom Arms - Silver



Product Data Sheet



Aluminium Boom Arms	
Part Nos	T57310 - 250mm - 0.84Kg T57315 - 500mm - 1.24Kg T57317 - 750mm - 1.65Kg T57320 - 1000mm - 2.50Kg
Tube Diameter	Ø48 - 51mm
Materials	Main Body - 6082 T6 Aluminium Roll Pins - Stainless Steel
Finish	Powder coated silver
Max Tightening	30Nm
WLL	T57310 - 100Kg T57315 - 50Kg T57317 - 37Kg T57320 - 25Kg
Factor of Safety	5:1
Approval	TÜV Approved

Dimensions in mm

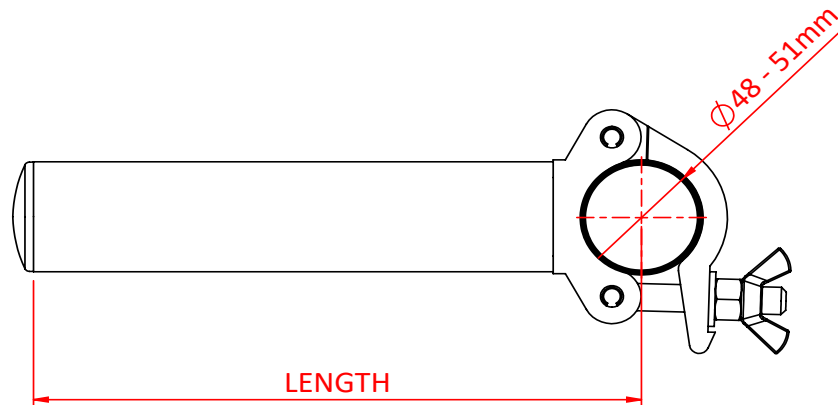
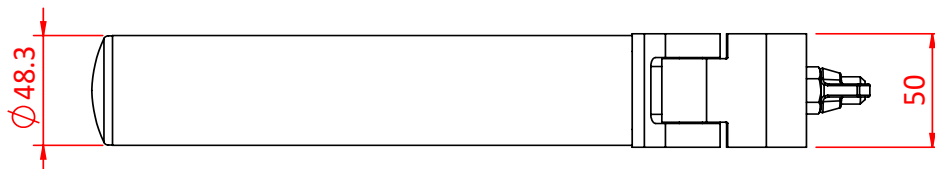

DIMENSIONS ARE A GUIDE ONLY AND MAY VARY